

КАРТА ИЗДЕЛИЯ

16.1.2017

AU3.2

1/2

Имя: **Монтажная коробка**
Монтажная коробка

Тип: AU3.2

EAN: 6410011523643

Описание: AU3.2 монтажная коробка, глубиной 47 мм.

Упаковка: 100

Единица: ШТ

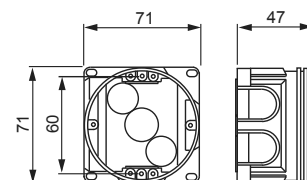

Техническая спецификация

Рабочее напряжение	400 V
Температура эксплуатации	-25 ... 90 °C
ETIM	
ETIM 5.0	EC002601 (EC002601)
ETIM 6.0	EC002601 (EC002601)
ETIM 6	
Mounting method	Flush mounted (plaster)
Shape	Round
Construction type	Device connection box (round/square)
Model	Single
Provided with revolving ring	
Can be coupled	1
Equipped with	None
Diameter	71 mm
Depth	47 mm
Internal depth	45 mm
For number of electric fittings	1
Mounting switching equipment	Screwing
With screws	1
For tubediameter	20/25 mm
Pipe locking	1
Inlet from the rear	1



Power and productivity
for a better world™

КАРТА ИЗДЕЛИЯ

16.1.2017

AU3.2

2/2

Number of inlets

Number of included spouts

Material	Plastic
Halogen free	1
Surface protection	Untreated
Colour	White
Degree of protection (IP)	Other
Cover	Not transparent
Cover attachment	Snapped on
Sealable	
Circuit integrity	None
With screening	
Wind proof	
Max. conductor cross section	0 mm ²
Number of poles of the clamp	
Clamp position fixed	
Luminaire hook mounting	
Nozzle	None
With nail lugs	1